

EVRIMA

OUR FLAGSHIP YACHT

With up to 298 guests aboard *Evrima*, taking in the view from your suite's private terrace as you drop anchor off a scenic shoreline. From the aft Marina, you can explore by kayak or paddle board before heading ashore. Five restaurants and six lounges offer an array of culinary delights, while legendary service and luxurious amenities complete the onboard experience.

SUITE CATEGORIES

- THE OWNER'S SUITES
- THE VIEW SUITES
- THE LOFT SUITES
- THE GRAND SUITES
- THE SIGNATURE MID SUITES
- THE SIGNATURE SUITES
- THE TERRACE MID SUITES
- THE TERRACE SUITES
- ACCESSIBLE SUITES ♿
- CONNECTING SUITES ↕
- CONVERTIBLE SUITES* ∞

SPECIFICATIONS

- GUEST CAPACITY _____ 298
- OFFICER AND CREW _____ 246
- TOTAL SUITES _____ 149
- TONNAGE _____ 26,500
- LENGTH _____ 624 FEET / 190 METERS
- WIDTH _____ 78 FEET / 23.8 METERS
- GUEST DECKS _____ 8
- BUILT _____ 2021
- YACHT'S REGISTRY _____ MALTA

**Select Terrace Suites have the ability to convert into an expanded living and dining area or remain a second bedroom when connected to the adjacent suite.

DECK 10

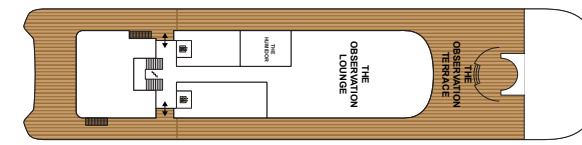

DECK 9

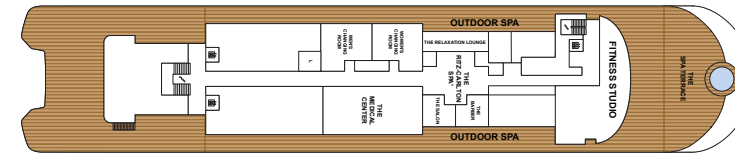

DECK 8

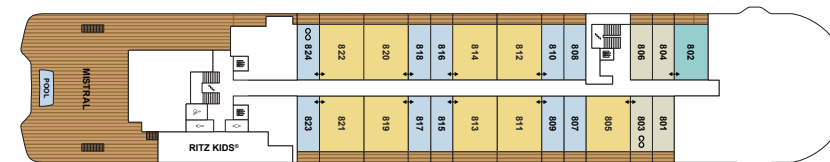

DECK 7

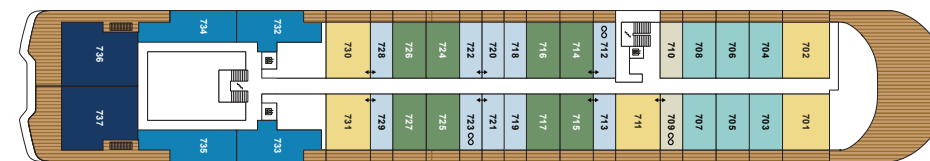

DECK 6

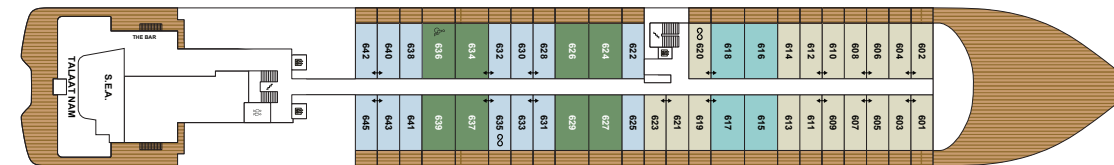

DECK 5

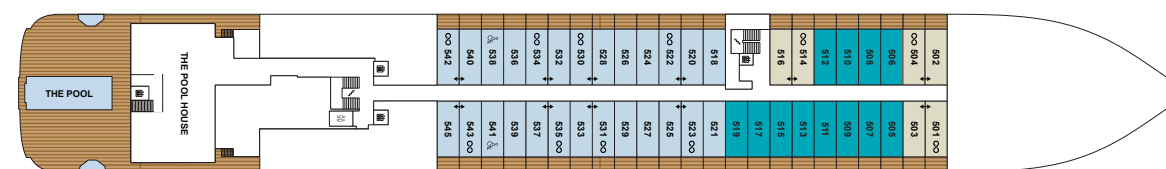

DECK 4

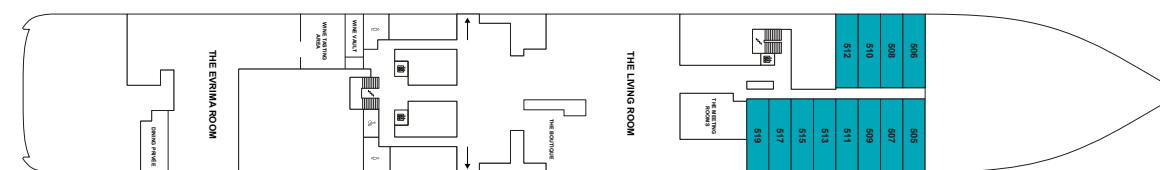

DECK 3

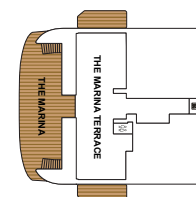

DECK 10

- THE OBSERVATION LOUNGE
- THE OBSERVATION TERRACE
- THE HUMIDOR

DECK 9

- THE GYM
- FITNESS STUDIO
- THE RITZ-CARLTON SPA®
- THE SPA TERRACE
- THE BARBER / THE SALON
- LAUNDERETTE
- THE MEDICAL CENTER

DECK 8

- MISTRAL
- RITZ KIDS®
- SUITES 801 – 824

DECK 7

- SUITES 701 – 737

DECK 6

- THE BAR
- S.E.A.
- TALAAT NAM
- SUITES 601 – 645

DECK 5

- THE POOL HOUSE
- THE POOL
- SUITES 501 – 545

DECK 4

- THE MEETING ROOMS
- THE LIVING ROOM
- THE BOUTIQUE
- THE EVRIMA ROOM
- DINING PRIVÉE
- WINE VAULT
- WINE TASTING AREA
- 505 – 519 LOWER LEVEL

DECK 3

- THE MARINA TERRACE
- THE MARINA